

How to set up your Freeview digital TV receiver

This is in Easy read



helping you go digital 

The Digital Switchover Help Scheme
operates by arrangement with



BBC

This information tells you how to set up your Freeview digital TV receiver.

This is what you should have.

This is the receiver.



This is the remote control.



These are the two batteries.



This is the mains adaptor.
You use it like a plug.



This is the SCART lead.

This is the RF cable.



You should also have:

- a booklet telling you how to use your Freeview digital TV receiver
- a booklet telling you about your new remote control.

Please follow these steps.

Important:

Make sure your TV is turned off and unplugged.

Make sure all your new equipment is turned off and unplugged.

Have a look at the back of your TV.

Is there a place where you can plug in the SCART lead?

If your TV is old you might not have a place for a SCART lead



is is the SCART lead.



It has a big flat head.



Yes - I can plug a SCART lead in.
Follow these steps.

This is what your receiver looks like at the back.



Plug your aerial lead in where it says AERIAL. This is the first socket on the picture.

A socket is where you plug in cables.

Then plug one end of the RF cable in where it says RF OUT. This is the second socket on the picture.

Plug the other end into the RF IN socket on your TV or VCR/DVD.



This is the RF lead

Then plug the SCART lead in where it says TV.
This is the fourth socket on the picture.

Plug the other end into your TV.



This is the SCART lead.

You will need another SCART lead.
You will have to get this yourself.

Plug a SCART lead in to your VCR/DVD.
Plug the other end into your receiver in where it says
VCR/DVD. This is the third socket on the picture.

Plug the mains adaptor in. This is the last socket on the
picture.

Then plug it in at the wall.



This is the mains adaptor.



No – I can't plug a SCART lead in.
Follow these steps.

This is what your receiver looks like at the back.



Plug your aerial lead in where it says AERIAL. This is the first socket on the picture.

Then plug one end of the RF cable in where it says RF OUT. This is the second socket on the picture.

Plug the other end into the TV.

This is the RF lead.



Plug the mains adaptor in. This is the last socket on the picture.

Then plug it in at the wall.



This is the mains adaptor.

You will need to set up a spare channel on your TV for the digital receiver. The receiver sends a signal on RF channel 68.

Putting batteries into the remote control.



This is the remote control.



These are the batteries.

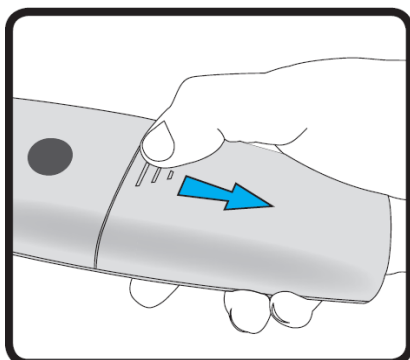

Open up the back of the remote control.
Slide the bottom half towards you.

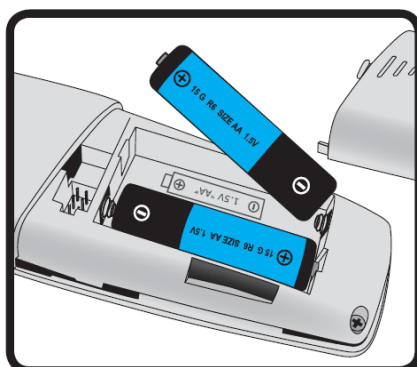

Put the batteries in.
You will see + and -.
These tell you which way round the
batteries go.

Put the cover back on.

How to use your remote control



These buttons turn your TV and receiver on and off (standby).

[0-9] You use these buttons to choose the channel you want. You also use them if you need to use your PIN number.

PIN – This is a number only you know. You will need to use it to get some channels and services. These will be channels you have to pay for.

[sub] This turns subtitles on or off.

[AD] This turns audio description on or off.

[guide] This shows you the TV guide.

[info] This shows you information about the TV programmes.

[back] This takes you back to what you were looking at before.



These buttons are for looking at the on-screen menus.

On-screen menus are lists that come up on your TV that tell you what you can watch or do.

[OK] Use this button to choose what you want from the on-screen menu.

[vol+] This turns the sound on your TV up.

[vol-] This turns the sound on your TV down.

[P+][P-] These let you go up and down the list of channels. You can use them to choose the channel you want to watch.

[exit] Use this when you have finished looking at the menu. It will take you back to the last programme you were watching.

[help] Use this to look at the help screen. Press it again when you have finished.

[text] This lets you look at teletext.

[menu] This lets you look at the main menu. Press it again when you have finished.



Use the red, green, blue and yellow buttons when you are looking at the text pages. Use them to choose what you want to look at.

[home] This takes you to the first channel on your list.
For most people this will be BBC 1.

[swap] Use this to change between the channel you are watching and the channel you were watching before.



Turns the sound on your receiver up or down.

[tv/radio] This lets you change from TV to radio and back again.

[tv input] You can only use this if your remote control has been set up to work the TV. You can find out about this in the booklet for the remote control.

Automatic tuning

This means getting all the different channels to work on your TV.



Turn on your TV.

Wait 10 seconds.



Then press the stand by button on the remote control for the receiver.



This will turn your receiver on.



This is what you should see on your TV.

[OK] Press OK on your remote control.



Your receiver will start to find your new TV and radio channels.

You will see the names come up on the TV.

When the receiver has found all the channels it will turn on to the first channel.

How to change channels

[P+][P-] Press the P+ or P- button down on your remote control.



[0-9] If you know the number of the channel you want you can use the number buttons on your remote control.

[OK] Press the number you want then press OK.

How to turn the sound on your TV up or down

[vol+] Press the Vol+ or Vol-button on your remote control.

[vol-] This will turn the sound up or down.



Audio description and subtitles.



Audio description is a voice that tells you what is happening on the TV when you are watching a programme. This is good if you find it hard to see the pictures on the TV.



Subtitles are words that come up on the screen so you can read what is being said. This is good if you find it hard to hear what is being said.

Sometimes you can get audio description or subtitles in different languages.

If you want to find out if a programme you are watching has audio description or subtitles:

[info] Press the info button on your remote control.



You will see these signs if the programme has got audio description or subtitles.





To get Audio description

[AD] Press the AD button on your remote control.



This will turn audio description on or off.

When you turn audio description on you will hear two long beeps. When you turn it off you will hear one long beep.

There is an accessibility set-up menu. This means you can set up audio description just the way you want it.

Your user guide will tell you how to do this.



To get subtitles

[sub] Press the sub button on your remote control.



This will turn subtitles on or off.

There is an accessibility set-up menu. This means you can set up audio description just the way you want it.

Your user guide will tell you how to do this.